

## Panelmonteret stikkontakt

Varenr. 1495



- skrueterminaler
- 20° hældning
- stikforbindelser kan udstyres med en hjælpekontakt

## Tekniske data

|                       |              |
|-----------------------|--------------|
| Ampere                | 32 A         |
| Poler                 | 4 p          |
| Volt                  | 230 V        |
| Klokposition          | 9 h          |
| Hertz                 | 50-60 Hz     |
| Forbindelsesteknologi | Skruekontakt |
| Kontakt               | standard     |
| Beskyttelsestype      | IP44         |
| Flange                | 100x92 mm    |
| Fikseringshul         | 85x77 mm     |
| Inklination           | 20°          |
| Vægt                  | 250 g        |

## Dimensioner

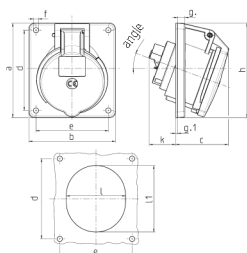

| Drawing<br>1 MB 260   | Amp.<br>Poles | 16   |     |     | 32  |     |     |
|---|---------------|------|-----|-----|-----|-----|-----|
|   |               | 3    | 4   | 5   | 3   | 4   | 5   |
| Dim. in mm  | a             | 73.5 | 100 | 100 | 100 | 100 | 100 |
|   | b             | 64   | 92  | 92  | 92  | 92  | 92  |
|   | c             | 50   | 59  | 58  | 62  | 62  | 61  |
|   | d             | 60   | 85  | 85  | 85  | 85  | 85  |
|   | e             | 52   | 77  | 77  | 77  | 77  | 77  |
|   | f             | 5.5  | 5.5 | 5.5 | 5.5 | 5.5 | 5.5 |
|   | g             | 7    | 8   | 8   | 8   | 8   | 8   |
|   | g.1           | 2    | 2   | 2   | 2   | 2   | 2   |
|   | h             | 79   | 100 | 100 | 103 | 103 | 106 |
|   | k             | 44   | 34  | 34  | 54  | 54  | 49  |
|   | l             | 52   | 55  | 65  | 67  | 67  | 72  |
|   | l1            | 60   | 63  | 72  | 82  | 82  | 85  |
|   | α             | 20°  | 20° | 20° | 20° | 20° | 20° |
| Terminal for cond. cross section (mm <sup>2</sup> ) min.-max. |               | 1.5  | 1.5 | 1.5 | 2.5 | 2.5 | 2.5 |
|   |               | -4   | -4  | -4  | -10 | -10 | -10 |